



From humble beginnings to being stronger than ever before, our philosophy at Hamer is simple: deliver the best quality electrical tools from around the world to the New Zealand market.

We are a 100% New Zealand family-owned business that has proudly supported other New Zealand businesses for over 75 years.

We import quality tools, power engineering and electrical products from around the world. Our products are found behind the scenes in power distribution networks, factories, commercial properties and anywhere humans control their environments – from water management in agriculture to air quality in the work space.

Hamer promises to 'Deliver Certainty' to the electrical industry, and we believe our quality products add an element of safety to every aspect of electrical activity in New Zealand. Whether it be the tools used in installation and maintenance or electrical components that energise and protect equipment, Hamer only distributes and supports quality products.

At Hamer we value:

- *Safety* – we care about the safety of our staff, customers and the public. Our products' quality and design are important to helping our customers avoid risk
- *Being Straight Up and Reliable* – we do what we say and we make it happen
- *Real People* – we are a professional team of individuals and we like to have fun
- *High Quality* – our service, people, solutions and products are aligned to only deliver quality results
- *Customer Centric* – our philosophy is to exceed customer expectations
- *Proud of Our Brands* – Hamer represents quality and performance

With expertise in a huge range of markets including Power Engineering, Electrical Wholesaling, HVAC and Refrigeration, Industrial, Commercial, Lighting and Telecommunications, our team really covers it all. Our customers love us because we get out in the field face to face, delivering what they need through a stable, reliable distribution platform. We have an intimate knowledge of our customers' needs, allowing us to find niche products from around the world specifically matched to local market requirements.

You will see our world leading brands in protected switching solutions, cable management systems and switchboards. Our people are never far away, advising our channel partners on the latest product releases, with knowledge and expertise from their years of industry experience. And when it comes to tools, we source the ones that last, allowing electricians and linemen to get the job done right.

Why Hamer?

We believe we can provide our clients three key promises which give them confidence that we can deliver certainty to their business.

- *Solutions* - Hamer will find the solution to your requirements, whether it be importing a new brand or providing a manufactured solution. We will leave no stone unturned.
- *Peace of mind* - our product selection criteria and policies ensure that our products meet strict criteria for safety, performance and value. Combined with our determined focus on service and delivery, you can rely on Hamer.
- *Long term reliability* - we only import the best brands, sourced from reliable and reputable suppliers around the world. While backing all products with industry leading warranties, support and after sales service.

Talk to our team to ensure you are getting the best value and reliability for your business and customers.

Delivering Certainty

| | |
|----------------------------------|------------|
| About us | |
| T11 Thermal Circuit Breakers | 1 |
| TA45 Rocker Switches | 3 |
| TA45 Illuminated Rocker Switches | 4 |
| TA45 with Under Voltage Release | 5 |
| T12 Thermal Circuit Breakers | 6 |
| T13 Thermal Circuit Breakers | 6 |
| T11, T12 + TA45 Accessories | 7 |
| T11 Dimensions | Appendix A |
| TA45 Dimensions | Appendix B |
| T12, T13 Dimensions | Appendix C |
| Index | |
| Warranties | |



SCHURTER

ELECTRONIC COMPONENTS

Schurter is a leading innovator, manufacturer and distributor of fuses, connectors, circuit breakers, input systems and EMC products – and an important service provider for the PCB assembly and electronics industries.

Order code: **WB2040**

Schurter T11 Thermal Circuit Breaker, Single Pole



- The T11 series of circuit breakers for equipment is a line of small, single pole push to reset, overload protective devices
- The trip mechanism is of the superior "latch type"
- The overload sensing is done with the aid of a thermal bimetal which has the advantage of being immune to high inrush currents and line transients
- All T11 units are positively trip-free
- Quick connect terminals
- Rated currents can be specified from 0,05A to 16A
- All models are internationally approved

D-5

| Hamer Code | Model Number | Rating (Amps) | |
|------------|--------------|---------------|-----------|
| WB2040 | T11 211 0.2 | 0.2 | |
| WB2060 | T11 211 0.3 | 0.3 | |
| WB2080 | T11 211 0.4 | 0.4 | |
| WB2100 | T11 211 0.5 | 0.5 | |
| WB2120 | T11 211 0.6 | 0.6 | |
| WB2140 | T11 211 0.7 | 0.7 | |
| WB2160 | T11 211 0.8 | 0.8 | |
| WB2180 | T11 211 1.0 | 1 | |
| WB2200 | T11 211 1.2 | 1.2 | |
| WB2220 | T11 211 1.5 | 1.5 | |
| WB2240 | T11 211 1.8 | 1.8 | |
| WB2400 | T11 211 2.0 | 2 | |
| WB2420 | T11 211 2.3 | 2.3 | |
| WB2440 | T11 211 2.5 | 2.5 | |
| WB2460 | T11 211 2.8 | 2.8 | |
| WB2500 | T11 211 3.0 | 3 | |
| WB2520 | T11 211 3.5 | 3.5 | |
| WB2540 | T11 211 4.0 | 4 | |
| WB2550 | T11 211 4.5 | 4.5 | |
| WB2560 | T11 211 5.0 | 5 | Cont..... |

Order code: **WB2570**
Schurter T11 Thermal Circuit Breaker, Single Pole (continued)

- The T11 series of circuit breakers for equipment is a line of small, single pole push to reset, overload protective devices
- The trip mechanism is of the superior “latch type”
- The overload sensing is done with the aid of a thermal bimetal which has the advantage of being immune to high inrush currents and line transients
- All T11 units are positively trip-free
- Quick connect terminals
- Rated currents can be specified from 0,05A to 16A
- All models are internationally approved

| Hamer Code | Model Number | Rating (Amps) | |
|------------|----------------|---------------|--|
| WB2570 | T11 211 5.5 | 5.5 | |
| WB2580 | T11 211 6.0 | 6 | |
| WB2600 | T11 211 6.5 | 6.5 | |
| WB2620 | T11 211 7.0 | 7 | |
| WB2630 | T11 211 7.5 | 7.5 | |
| WB2640 | T11 211 8.0 | 8 | |
| WB2660 | T11 211 9.0 | 9 | |
| WB2280 | T11 211 10.235 | 10.235 | |
| WB2300 | T11 211 12.0 | 12 | |
| WB2320 | T11 211 13.0 | 13 | |
| WB2340 | T11 211 14.0 | 14 | |
| WB2360 | T11 211 15.0 | 15 | |
| WB2380 | T11 211 16.0 | 16 | |

Order code: **WB3634****Schurter TA45 Rocker Switch**

- Schurter TA45 Rocker Switch
- Snap-in style with quick connect terminals
- 2 Pole Rocker actuated switch with 1 pole thermal overload protection

D-5



| Hamer Code | Model Number | Rating (Amps) | |
|------------|---------------|---------------|--|
| WB3634 | ABT WF J18 C0 | 1.8 | |
| WB3638 | ABT WF 035 C0 | 3.5 | |
| WB3680 | ABT WF 040 C0 | 4 | |
| WB3642 | ABT WF 050 C0 | 5 | |
| WB3644 | ABT WF 060 C0 | 6 | |
| WB3646 | ABT WF 070 C0 | 7 | |
| WB3648 | ABT WF 080 C0 | 8 | |
| WB3650 | ABT WF 090 C0 | 9 | |
| WB3600 | ABT WF 100 C0 | 10 | |
| WB3620 | ABT WF 120 C0 | 12 | |
| WB3625 | ABT WF 140 C0 | 14 | |
| WB3682 | ABT WF 150 C0 | 15 | |
| WB3640 | ABT WF 160 C0 | 16 | |
| WB3684 | ABT WF 200 C0 | 20 | |

Order code: **WB3706**

Schurter TA45 Rocker Switch with Illuminated Switch



- Schurter TA45 Rocker Switch with Illuminated Switch
- Snap-in style with quick connect terminals
- 2 Pole Rocker actuated switch with 1 pole thermal overload protection and illuminated switch

| Hamer Code | Model Number | Rating (Amps) | |
|------------|---------------|---------------|--|
| WB3706 | A12 6F J10 C0 | 1 | |
| WB3722 | A12 6F 030 C0 | 3 | |
| WB3950 | A12 6F 140 C0 | 14 | |
| WB3711 | A12 6F 160 C0 | 16 | |

Order code: **WB3730**

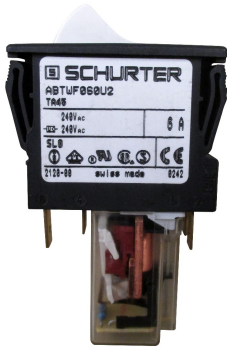

Schurter TA45 Rocker Switch with Under Voltage Release Coil

- Schurter TA45 Rocket Switch with Under Voltage Release Coil
- Snap-in style with quick connect terminals
- 2 Pole Rocker actuated switch with 1 pole thermal overload protection and under voltage release coil
- Rating (Amps) 6
- Model number ABT WF 060 U2

Order code: **WB3774**



Schurter TA45 Rocker Switch with Under Voltage Release Coil & Illuminated Switch

- TA45 Rocker Switch with Under Voltage Release Coil & Illuminated Switch
- Snap-in style with quick connect terminals
- 2 Pole Rocker actuated switch with 1 pole thermal overload protection, under voltage release coil & orange illuminated switch
- Rating (Amps) 15
- Model Number A12 6F 150 U2

Undervoltage release

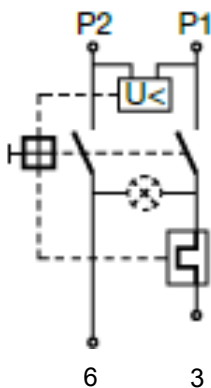

Order code: **WB3388**
Schurter T12 Thermal Circuit Breaker

- Schurter T12 Thermal Circuit Breaker features;
- Single pole thermal overload protection switch
- Positively trip free
- Threaded neck
- Manual on/off (push/push)
- Screw clamp terminals

| Hamer Code | Model Number | Rating (Amps) |
|---------------|---------------|---------------|
| WB3388 | T12 222 3.5 | 3.5 |
| WB3400 | T12 222R 10.0 | 10 |

Order code: **WB3464**
Schurter T13 Thermal Circuit Breaker

- Schurter T13 Thermal Circuit Breaker features;
- Single pole thermal overload protection switch
- Positively trip free
- Threaded neck
- Reset Type
- Screw clamp terminals

| Hamer Code | Model Number | Rating (Amps) |
|---------------|---------------|---------------|
| WB3464 | T13 212 8.0 | 8 |
| WB3466 | T13 212 15 | 15 |
| WB3467 | T13 212 20 | 20 |
| WB3460 | T13 211R 30.0 | 30 |

Order code: **WB2000**



Schurter T11/T13 (TZZ01) Dust Cover IP54

- Schurter Dust Cover to fit T11/T13 Thermal Circuit Breakers
- IP54

Order code: **WB4010**



Schurter AZM11 TA45 Rocker Switch Cover

- Schurter TA45 Rocket Switch Cover
- Model Number AZM11
- IP54
- Optional accessory
- Other models available via Indent

Order code: **WB4002**



Schurter AZZ51 WHH Rear Terminal Shroud

- Schurter WHH 2 pole Rear Terminal Shroud for TA45 rocker switches
- Model Number AZZ51
- IP40

T11-211

Schematic diagrams

Rated current
 $\leq 7,5 \text{ A}$

Rated current
 $> 7,5 \text{ A}$

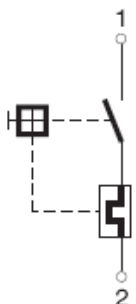
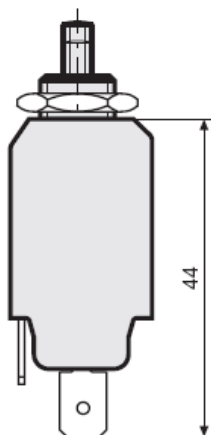

T11-211

Maximum torque 0,6 Nm

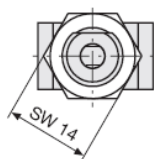
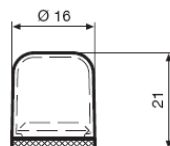
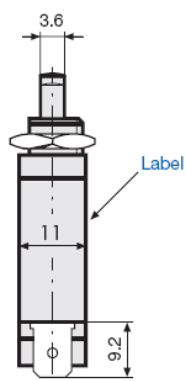
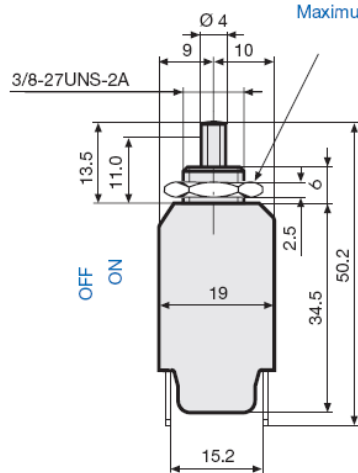

Cut-out

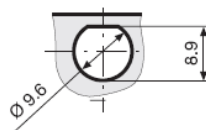

TA45 General Description

The TA45 series of circuit breakers for equipment are double pole rocker actuated devices for on/off switching and overload protection. They conveniently snap into a rectangular cut out and are connected to the wiring via 6.3mm quick connect terminals.

Features

- Worldwide approvals include UL, CSA and VDE etc...
- UL-approved as a motor starter for up to 1.5 HP motors
- Long life, sturdy mechanical construction
- Tripping occurs by a sustained overload, low line voltage, relay trip coil or safety mechanical trip

Technical Information

| | |
|------------------------|--|
| Current Ratings: | 0.05-16A double pole thermal protected > 16-20A at 120 V AC single pole thermal protected with parallel contacts |
| Voltage Ratings: | 240 V AC, 60 V DC |
| Interrupting Capacity: | 2000 A acc. To UL 1077 |
| Breaking Capacity: | $I_n < 7A$, $8 \times I_n$ to IEC 934 $I_n \geq 7A$, = 200 Amps max. |
| Electrical Life: | 50,000 cycles at rated current and resistive load |

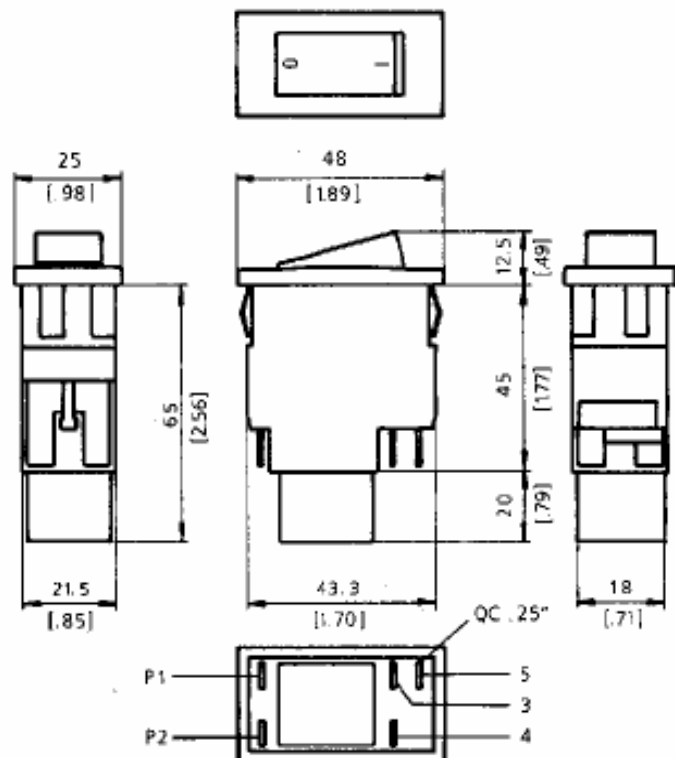
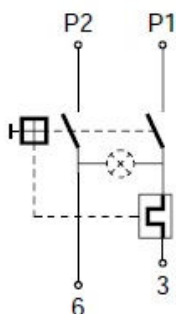

T12 Thermal Circuit Breaker

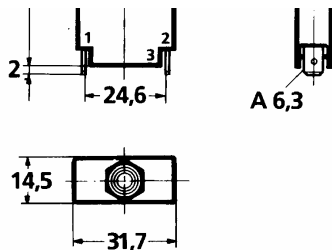

T13 Thermal Circuit Breaker

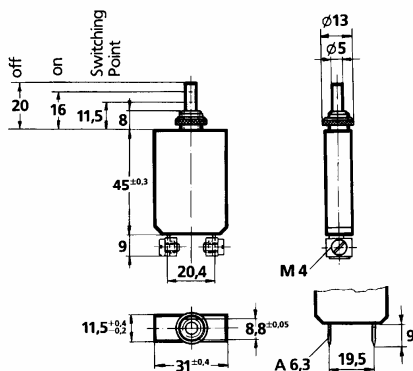

| HAMER CODE | CAT# | PAGE | HAMER CODE | CAT# | PAGE | HAMER CODE | CAT# | PAGE |
|------------|--------------------|------|------------|-----------|------|------------|------|------|
| WB2000 | T11 /T1 (TZZ01) | 7 | WB4002 | 4430.0519 | 7 | | | |
| WB2040 | T11 211 0.2 | 1 | WB4010 | 4430.1172 | 7 | | | |
| WB2060 | T11 211 0.3 | 1 | | | | | | |
| WB2080 | T11 211 0.4 | 1 | | | | | | |
| WB2100 | T11 211 0.5 | 1 | | | | | | |
| WB2120 | T11 211 0.6 | 1 | | | | | | |
| WB2140 | T11 211 0.7 | 1 | | | | | | |
| WB2160 | T11 211 0.8 | 1 | | | | | | |
| WB2180 | T11 211 1.0 | 1 | | | | | | |
| WB2200 | T11 211 1.2 | 1 | | | | | | |
| WB2220 | T11 211 1.5 | 1 | | | | | | |
| WB2240 | T11 211 1.8 | 1 | | | | | | |
| WB2280 | T11 211 10.235 | 2 | | | | | | |
| WB2300 | T11 211 12.0 | 2 | | | | | | |
| WB2320 | T11 211 13.0 | 2 | | | | | | |
| WB2340 | T11 211 14.0 | 2 | | | | | | |
| WB2360 | T11 211 15.0 | 2 | | | | | | |
| WB2380 | T11 211 16.0 | 2 | | | | | | |
| WB2400 | T11 211 2.0 | 1 | | | | | | |
| WB2420 | T11 211 2.3 | 1 | | | | | | |
| WB2440 | T11 211 2.5 | 1 | | | | | | |
| WB2460 | T11 211 2.8 | 1 | | | | | | |
| WB2500 | T11 211 3.0 | 1 | | | | | | |
| WB2520 | T11 211 3.5 | 1 | | | | | | |
| WB2540 | T11 211 4.0 | 1 | | | | | | |
| WB2550 | T11 211 4.5 | 1 | | | | | | |
| WB2560 | T11 211 5.0 | 1 | | | | | | |
| WB2570 | T11 211 5.5 | 2 | | | | | | |
| WB2580 | T11 211 6.0 | 2 | | | | | | |
| WB2600 | T11 211 6.5 | 2 | | | | | | |
| WB2620 | T11 211 7.0 | 2 | | | | | | |
| WB2630 | T11 211 7.5 | 2 | | | | | | |
| WB2640 | T11 211 8.0 | 2 | | | | | | |
| WB2660 | T11 211 9.0 | 2 | | | | | | |
| WB3388 | T12 222 3.5 | 6 | | | | | | |
| WB3400 | T12 222R 10.0 | 6 | | | | | | |
| WB3460 | T13 211R 30.0 | 6 | | | | | | |
| WB3464 | T13 212 8.0 | 6 | | | | | | |
| WB3466 | T13 212 15 | 6 | | | | | | |
| WB3467 | T13 212 20 | 6 | | | | | | |
| WB3600 | ABT WF 100 C0 | 3 | | | | | | |
| WB3620 | ABT WF 120 C0 | 3 | | | | | | |
| WB3625 | ABT WF 140 C0 | 3 | | | | | | |
| WB3634 | ABT WF J18 C0 | 3 | | | | | | |
| WB3638 | ABT WF 035 C0 | 3 | | | | | | |
| WB3640 | ABT WF 160 C0 | 3 | | | | | | |
| WB3642 | ABT WF 050 C0 | 3 | | | | | | |
| WB3644 | ABT WF 060 C0 | 3 | | | | | | |
| WB3646 | ABT WF 070 C0 | 3 | | | | | | |
| WB3648 | ABT WF 080 C0 | 3 | | | | | | |
| WB3650 | ABT WF 090 C0 | 3 | | | | | | |
| WB3680 | ABT WF 040 C0 | 3 | | | | | | |
| WB3682 | ABT WF 150 C0 | 3 | | | | | | |
| WB3684 | ABT WF 200 C0 | 3 | | | | | | |
| WB3706 | A12 6F J10 C0 | 4 | | | | | | |
| WB3711 | A12 F6 160 C0 | 4 | | | | | | |
| WB3722 | A12 6F 030 C0 | 4 | | | | | | |
| WB3730 | TA45 ABT WF 060 U2 | | | | | | | |
| WB3774 | 4430.212 | 5 | | | | | | |
| WB3950 | A12 6F 140 C0 | 4 | | | | | | |

| CAT# | HAMER CODE | PAGE | CAT# | HAMER CODE | PAGE | CAT# | HAMER CODE | PAGE |
|-----------------|------------|------|-------------------------|------------|------|------|------------|------|
| 4430.0519 | WB4002 | 7 | T13 212 8.0 | WB3464 | 6 | | | |
| 4430.1172 | WB4010 | 7 | TA45 ABT WF 060 UWB3730 | | 5 | | | |
| 4430.212 | WB3774 | 5 | | | | | | |
| A12 6F 030 C0 | WB3722 | 4 | | | | | | |
| A12 6F 140 C0 | WB3950 | 4 | | | | | | |
| A12 6F J10 C0 | WB3706 | 4 | | | | | | |
| A12 F6 160 C0 | WB3711 | 4 | | | | | | |
| ABT WF 035 C0 | WB3638 | 3 | | | | | | |
| ABT WF 040 C0 | WB3680 | 3 | | | | | | |
| ABT WF 050 C0 | WB3642 | 3 | | | | | | |
| ABT WF 060 C0 | WB3644 | 3 | | | | | | |
| ABT WF 070 C0 | WB3646 | 3 | | | | | | |
| ABT WF 080 C0 | WB3648 | 3 | | | | | | |
| ABT WF 090 C0 | WB3650 | 3 | | | | | | |
| ABT WF 100 C0 | WB3600 | 3 | | | | | | |
| ABT WF 120 C0 | WB3620 | 3 | | | | | | |
| ABT WF 140 C0 | WB3625 | 3 | | | | | | |
| ABT WF 150 C0 | WB3682 | 3 | | | | | | |
| ABT WF 160 C0 | WB3640 | 3 | | | | | | |
| ABT WF 200 C0 | WB3684 | 3 | | | | | | |
| ABT WF J18 C0 | WB3634 | 3 | | | | | | |
| T11 /T1 (TZZ01) | WB2000 | 7 | | | | | | |
| T11 211 0.2 | WB2040 | 1 | | | | | | |
| T11 211 0.3 | WB2060 | 1 | | | | | | |
| T11 211 0.4 | WB2080 | 1 | | | | | | |
| T11 211 0.5 | WB2100 | 1 | | | | | | |
| T11 211 0.6 | WB2120 | 1 | | | | | | |
| T11 211 0.7 | WB2140 | 1 | | | | | | |
| T11 211 0.8 | WB2160 | 1 | | | | | | |
| T11 211 1.0 | WB2180 | 1 | | | | | | |
| T11 211 1.2 | WB2200 | 1 | | | | | | |
| T11 211 1.5 | WB2220 | 1 | | | | | | |
| T11 211 1.8 | WB2240 | 1 | | | | | | |
| T11 211 10.235 | WB2280 | 2 | | | | | | |
| T11 211 12.0 | WB2300 | 2 | | | | | | |
| T11 211 13.0 | WB2320 | 2 | | | | | | |
| T11 211 14.0 | WB2340 | 2 | | | | | | |
| T11 211 15.0 | WB2360 | 2 | | | | | | |
| T11 211 16.0 | WB2380 | 2 | | | | | | |
| T11 211 2.0 | WB2400 | 1 | | | | | | |
| T11 211 2.3 | WB2420 | 1 | | | | | | |
| T11 211 2.5 | WB2440 | 1 | | | | | | |
| T11 211 2.8 | WB2460 | 1 | | | | | | |
| T11 211 3.0 | WB2500 | 1 | | | | | | |
| T11 211 3.5 | WB2520 | 1 | | | | | | |
| T11 211 4.0 | WB2540 | 1 | | | | | | |
| T11 211 4.5 | WB2550 | 1 | | | | | | |
| T11 211 5.0 | WB2560 | 1 | | | | | | |
| T11 211 5.5 | WB2570 | 2 | | | | | | |
| T11 211 6.0 | WB2580 | 2 | | | | | | |
| T11 211 6.5 | WB2600 | 2 | | | | | | |
| T11 211 7.0 | WB2620 | 2 | | | | | | |
| T11 211 7.5 | WB2630 | 2 | | | | | | |
| T11 211 8.0 | WB2640 | 2 | | | | | | |
| T11 211 9.0 | WB2660 | 2 | | | | | | |
| T12 222 3.5 | WB3388 | 6 | | | | | | |
| T12 222R 10.0 | WB3400 | 6 | | | | | | |
| T13 211R 30.0 | WB3460 | 6 | | | | | | |
| T13 212 15 | WB3466 | 6 | | | | | | |
| T13 212 20 | WB3467 | 6 | | | | | | |

Cable Care

- **HellermannTyton** - Cable ties & insulation tape
12 months
- **Sharpie** - Permanent markers / pens
1 month
- **Dymo** - Labelling machines and labels
12 months
- **Pemsa** - Mesh cable tray
12 months

Electrical Components

- **Flexelec** - Heat trace cables & accessories
12 months
- **GEN3** - Industrial switchgear
12 months

Motor Accessories & Control

- **Comar** - Capacitors
12 months
- **Lovato** - Motor control
12 months
- **Schurter** - Overloads
12 months

Power Engineering

- **Bowthorpe** - Line taps & accessories
12 months
- **Klein** - Chicago grips
Working Lifetime

Power Protection & Safety

- **Spikefree** - Surge protected power boards
12 months
- **Powersafe** - Guardian & Duo power boards
5 Year Pro rata

Test Meters

- **Klein** - Multimeters & clamp meters
24 months

Tools

- **Klein** - Hand tools
Working Lifetime
- **Klauke** - Hand tools
12 months
- **Klauke** - Battery operated tools
24 months
- **Hamer Bags** - Bags & pouches
3 months
- **Taurus** - Leather
Working Lifetime
- **Greenlee**
12 months

Automation & Control

- **Schmersal** - Safety & automation systems
12 months
- **Theben** - Timers, sensors & temperature controllers
12 months
- **Flash** - Timers & temperature controllers
12 months

HVAC & Refrigeration

- **Polyslab** - Air conditioning bases
3 months
- **Saginomiya** - Pressure, temperature & refrigeration
12 months
- **Rectorseal** - Mighty Bracket
12 months

Contact Us Today.

Our team is here to answer any questions you may have. Whether it be sales, distribution, warranty or after sales service, let us know how we can help.

Call us today:

0800 239 239

Christchurch branch details:

Christchurch
85a Falsgrave St
Phillipstown
8011

Auckland branch details:

Auckland
29 Olive Road
Penrose
1061

hamer.co.nz

0800 239 239

sales@hamer.co.nz