

SEW TEST BOX

Functional checking for RCD testers, Loop Testers & Insulation/Continuity Testers

Part# 6280TB



Features

- Operating voltage: 210V/50Hz to 250V/50Hz AC
- For checking:
 - AC voltage
 - RCD tester's current & time in mA(ms)
 - Loop tester
 - Wiring (Phase, Neutral, Earth)
 - Continuity
 - Insulation (the maximum is 1.2kV)

See Over for Technical Specs 

 1300 555 586
 repelec.com.au

rep **ELEC**
TRADE SOLUTIONS



@RepelecAU

Layout of the front panel

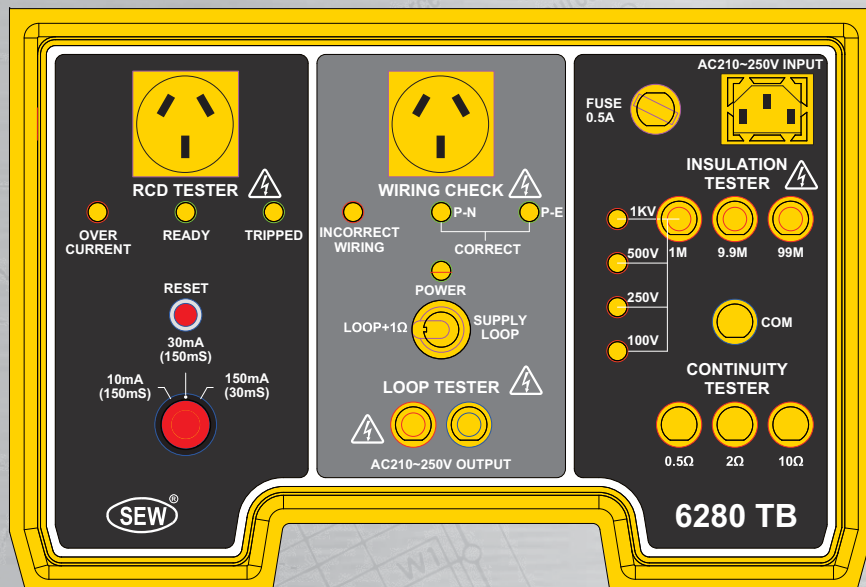

6280TB is an ideal tool which provides verification of Insulation testers, continuity testers, RCD testers and loop testers.

SPECIFICATIONS

RCD Testing

Range	10mA @ 150ms
	30mA @ 150ms
	150mA @ 30ms

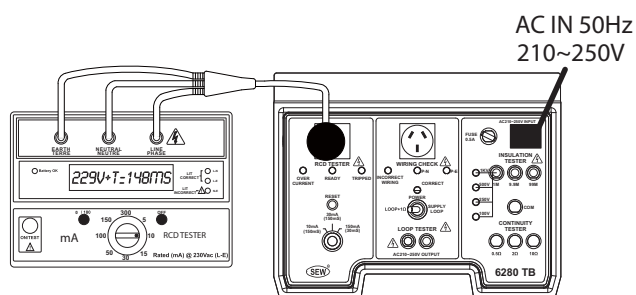

Insulation Testing

Range	1MΩ / 9.9MΩ / 99MΩ
Accuracy	± 1%
Max. Testing	1.2kV

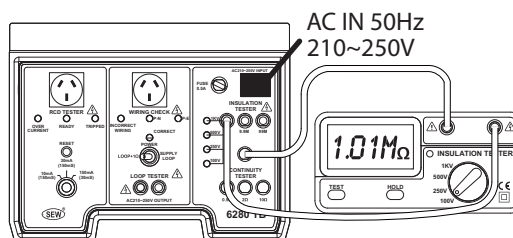

Continuity Testing

Range	0.5Ω / 2Ω / 10Ω
Accuracy	± 0.05Ω / ± 0.1Ω / ± 0.2Ω
Max. Current	300mA

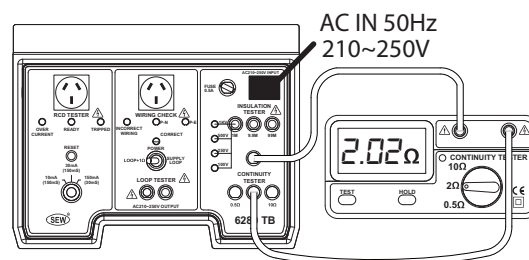

LOOP Testing

Range	Supply Loop / Supply Loop +1Ω
Accuracy	0.45Ω ± 0.05Ω / 1.45Ω ± 0.05Ω

- Dimension: 330(L)x260(W)x160(D)mm
- Weight: Approx. 2570g

