

## Datasheet - IFL 50-385-11P-M20

Inductive proximity switch / Housing construction form: Block / IFL 385



Preferred typ



- Design 385
- Thermoplastic enclosure
- DC 4-wire
- Double-insulated
- Wiring compartment
- 3 cable entries M 20 x 1.5

(Minor differences between the printed image and the original product may exist!)

### Ordering details

Product type description	IFL 50-385-11P-M20
Article number	101174071
EAN code	4030661303239
eCl@ss	27-27-01-01

### Approval

Approval



### Global Properties

Product name	IFL - 385
Standards	IEC/EN 60947-5-2; DIN VDE 0660-208
Compliance with the Directives (Y/N)	Yes
Operating resource protection class	Protection class 2
Materials	
- Material of the housings	Plastic
Housing coating	None
Housing construction form	Block
Weight	415 g

### Mechanical data

---

Design of electrical connection	Screw connection
Conductor with strain relief	No
Cable section	
- Min. Cable section	
- Max. Cable section	2 x 1.5 mm <sup>2</sup>
mechanical installation conditions	not flush
Switch distance 70 mm available on request	
Switch distance	50 mm
Reduction factor 1 met (Y/N)	No
Protection circuit	inductive interference protection, Protection against polarity reversal
Pressure resistant (Y/N)	No

### Ambient conditions

---

Ambient temperature	
- Min. environmental temperature	-25 °C
- Max. environmental temperature	+70 °C
Protection class	IP67 to IEC/EN 60529

### Electrical data

---

Design of control element	Normally open contact (NO) and Opener (NC) (antivalent)
Number of wire	4 piece
Voltage type	DC, direct current
Supply voltage U <sub>B</sub>	
- Min. supply voltage	10 V
- Max. supply voltage	60 V
Switch frequency	approx. 25 Hz
Voltage drop U <sub>d</sub>	approx. 1.5 V (400 mA)
Operating current I <sub>e</sub>	400 mA
No-load current I <sub>0</sub>	approx. 5.5 mA (24 V)

### Outputs

---

Design of control output	PNP
--------------------------	-----

### LED switching conditions display

---

LED switching conditions display (Y/N)	Yes
- yellow LED	

### ATEX

---

Explosion protection categories for gases	None
Explosion protected category for dusts	None

### Dimensions

---

Dimensions of the sensor	
- Width of sensor	80 mm
- Height of sensor	135 mm
- Length of sensor	40 mm



## notice

Mounting angle HW 385-1 to simplify mounting available

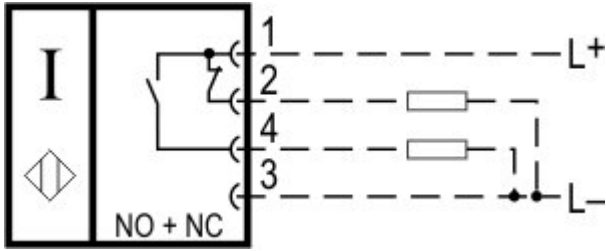
## Diagram

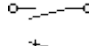
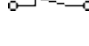

Note Diagram

-  positive break NC contact
-  active
-  no active
-  Normally-open contact
-  Normally-closed contact

## Ordering suffix

The applicable ordering suffix is added at the end of the part number of the safety switch.

Order example: IFL 50-385-11P-M20-**1665-1**

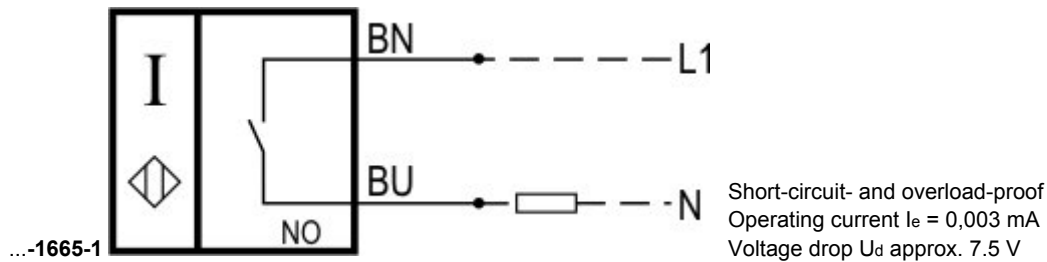

## Ordering code

IFL (1)-(2)-(3)(4)(5)(6)(7)

(1)

50

Switch distance 50 mm

(2)

385

Block Design, 135 x 80 x 40 mm

(3)

01

Opener (NC)

10

Normally open contact (NO)

10/01

Normally open contact (NO) / Opener (NC) with Wiring compartment

11

Normally open contact (NO) / Opener (NC) antivalent

(4)

without

Cable

D

DC 2-wire

(5)

Z

Protection class IP67

(6)

N

n-type

P

p-type

(7)

2130

Max. +130°C, without LED switching conditions display

## Documents

---

**Mounting and wiring instructions** (de, en, fr, it) 79 kB, 05.10.2010

Code: m\_fl1p01

**Declaration of conformity** (en, de) 232 kB, 05.11.2013

Code: \_\_iflp01

**CCC certification** (en) 606 kB, 23.06.2014

Code: q\_iflp01

**CCC certification** (cn) 620 kB, 23.06.2014

Code: q\_iflp04

## Images

---

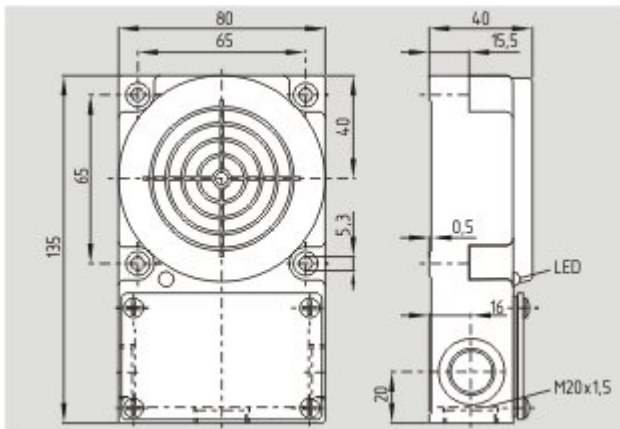

Dimensional drawing (basic component)

---

K.A. Schmersal GmbH & Co. KG, Möddinghofe 30, D-42279 Wuppertal

The data and values have been checked thoroughly. Technical modifications and errors excepted.

Generiert am 22.04.2016 - 22:07:47h Kasbase 3.2.2.F.64I