

## Datasheet - IFL 5-18-10STP-2033

Inductive proximity switch / Housing construction form: cylinder, thread / IFL - M18



- Design M 18 x 1
- Metal enclosure
- DC 3-wire
- Connector M12

(Minor differences between the printed image and the original product may exist!)

### Ordering details

Product type description	IFL 5-18-10STP-2033
Article number	101115291
EAN code	4030661008950
eCl@ss	27-27-01-01

### Global Properties

Product name	IFL - M18
Standards	IEC/EN 60947-5-2; DIN VDE 0660-208
Compliance with the Directives (Y/N) 	Yes
Operating resource protection class	None
Materials	
- Material of the housings	Stainless steel
- Material of the nuts	Stainless steel
- Material of the active surface	Plastic
Housing coating	None
Housing construction form	cylinder, thread
Weight	49 g

### Mechanical data

Design of electrical connection	Connector M12
Conductor with strain relief	No

mechanical installation conditions	flush
Switch distance	5 mm
Reduction factor 1 met (Y/N)	No
Protection circuit	inductive interference protection, Protection against polarity reversal, short-circuit and overload proof
Pressure resistant (Y/N)	No

## Ambient conditions

---

Ambient temperature	
- Min. environmental temperature	-25 °C
- Max. environmental temperature	+70 °C
Protection class	IP67 to IEC/EN 60529

## Electrical data

---

Design of control element	Normally open contact (NO)
Number of wire	3 piece
Voltage type	DC, direct current
Supply voltage $U_b$	
- Min. supply voltage	10 V
- Max. supply voltage	30 V
Switch frequency	approx. 600 Hz
Voltage drop $U_d$	approx. 1.2 V (200 mA)
Operating current $I_e$	200 mA
No-load current $I_0$	approx. 3 mA (24 V)

## Outputs

---

Design of control output	PNP
--------------------------	-----

## LED switching conditions display

---

LED switching conditions display (Y/N)	Yes
- yellow LED	

## ATEX

---

Explosion protection categories for gases	None
Explosion protected category for dusts	None

## Dimensions

---

Dimensions of the sensor	
- Length of sensor	71.4 mm
- Diameter of sensor	M18

## notice

---

Instead of nuts, a mounting clamp can be provided.

## Diagram

---

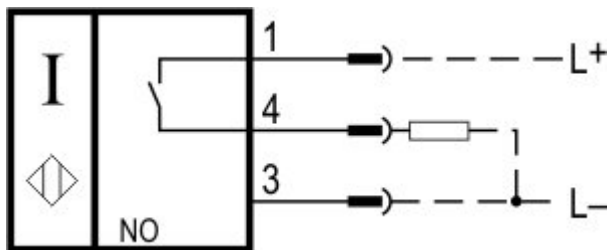

Note Diagram

- positive break NC contact
- active
- no active
- Normally-open contact
- Normally-closed contact

### Ordering code

IFL (1)-(2)(3)-(4)(5)(6)(7)-(8)	
(1)	
5	Switch distance 5 mm
8	Switch distance 8 mm
10	Switch distance 10 mm
(2)	
18	cylinder, thread M18, Metal film
180	cylinder, thread M18, Plastic
(3)	
without	Included in standard version Design
M	miniature body
L	Long design
(4)	
01	Opener (NC)
10	Normally open contact (NO)
10/01	Normally open contact (NO) / Opener (NC) with Wiring compartment
11	Normally open contact (NO) / Opener (NC) antivalent
(5)	
without	Cable
ST	Connector
T	Conductor with strain relief
A	Alternating current/direct current AC/DC
D	DC 2-wire
(6)	
without	Included in standard version Plug-in connection
2	Alternative Plug-in connection
(7)	
N	n-type
P	p-type
(8)	
2033	Stainless steel enclosure
2130	Max. +130°C, without LED switching conditions display

### Documents

**Mounting and wiring instructions** (de, en, fr, it) 79 kB, 05.10.2010

Code: m\_fl1p01

**Declaration of conformity** (en, de) 232 kB, 05.11.2013

Code: \_\_iflp01

## Images

---

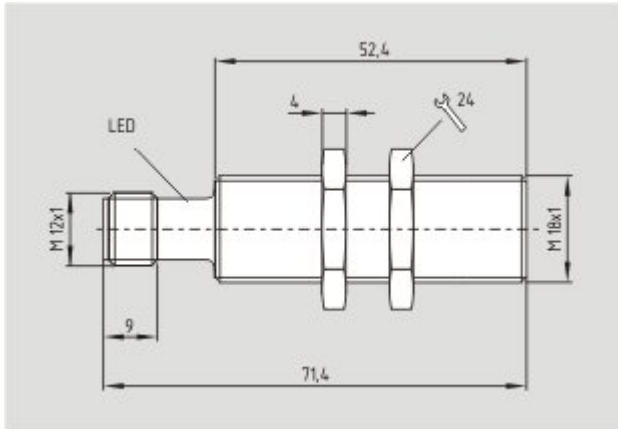

Dimensional drawing (basic component)

---

## System components

---

### Mounting accessories



#### 101068879 - MOUNTING CLAMP H 18

- For a smooth fitting of the proximity switches with cylindric shape Ø 18 mm or thread M18

---

K.A. Schmersal GmbH & Co. KG, Möddinghofe 30, D-42279 Wuppertal

The data and values have been checked thoroughly. Technical modifications and errors excepted.

Generiert am 19.01.2016 - 00:05:08h Kasbase 3.2.1.F.64I