

EN Motion detector

LUXA 103-100 AP WH
1030022

LUXA 103-101 AP WH
1030023



1. Basic safety information



WARNING

Danger of death through electric shock or fire!

➤ Installation should only be carried out by a qualified electrician!

- The device conforms with EN 60669-2-1 if installed correctly

2. Proper use

- Motion detector for automatic lighting control dependent on presence and brightness (LUXA 103-100 AP); LUXA 103-101 AP: suitable for automatic lighting and HVAC control (HVAC switches on regardless of brightness)
- Suitable for ceiling installation indoors with back boxes
- Suitable for toilets, small rooms, workplaces, offices, etc.

Disposal

- Dispose of the device in an environmentally sound manner (electronic waste)

3. Device description

3 potentiometers for setting time delay (TIME), brightness value (LUX) and detection area (METRES) (under the cover); additional setting of HVAC time (TIME 2) in the case of LUXA 103-101 AP

red LED

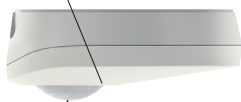

4. Installation and connection

- ⚠ Secure device with an upstream type C circuit breaker (EN 60898-1) with a maximum of 10 A (channel 1)
- ⚠ Secure device with an upstream type C circuit breaker (EN 60898-1) with a maximum of 6 A (HVAC channel 2)

Installing the motion detector

- ⓘ Installation height: 2 – 3 m
- ⓘ Motion detector requires clear line of sight to people

- Disconnect power source

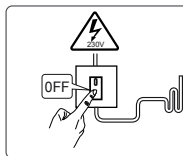

- Carefully lift the outer cover with a screwdriver and unscrew the upper housing part

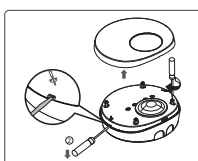
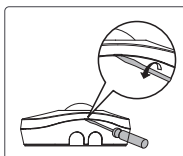

- Observe the break-outs for flush-mounting socket

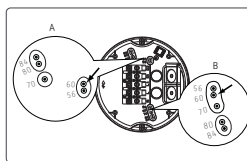

- Strip cable to 6 – 8 mm

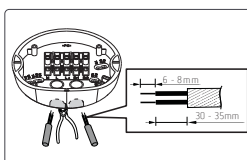

- Make marks for the holes and drill the holes

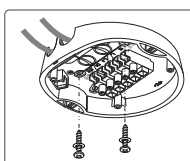

- Fix the base to the ceiling, connect the individual wires to the appropriate terminal and tighten the screws
- Screw on the housing

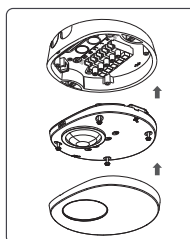

- Make settings at the potentiometers
- Put on the cover and close catch mechanism
- Connect motion detector to power supply

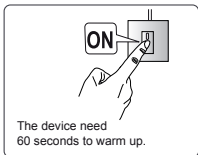

Connecting the motion detector

⚠ WARNING
Danger of death through electric shock or fire!
 ➤ Installation should only be carried out by a qualified electrician!

- Disconnect power source
- Ensure device cannot be switched on
- Check absence of voltage
- Earth and bypass
- Cover or shield any adjacent live components

The warm-up phase takes approx. 60 s. The LED is permanently red.

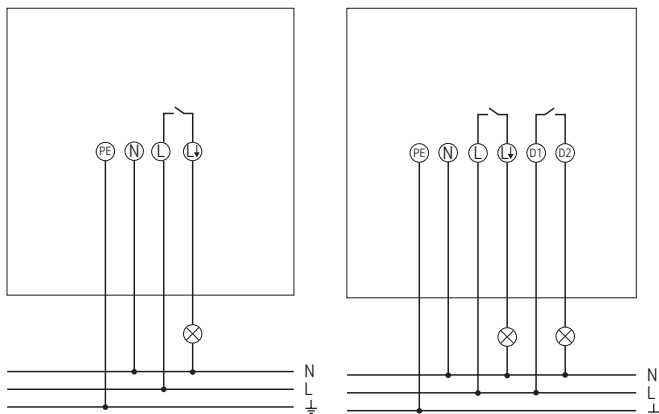

LUXA 103-100 AP

LUXA 103-101 AP

Installation instructions and detection area

As the detector reacts to variations in temperature, avoid the following situations:

- Do not direct motion detectors at objects with highly-reflective surfaces such as mirrors, etc.
- Do not install the motion detector near heat sources, such as heating outlets, air conditioning systems, lamps, etc.
- Do not direct the motion detector at objects that move in the wind, such as curtains, large plants, etc.
- Pay attention to the direction of motion during the test run.

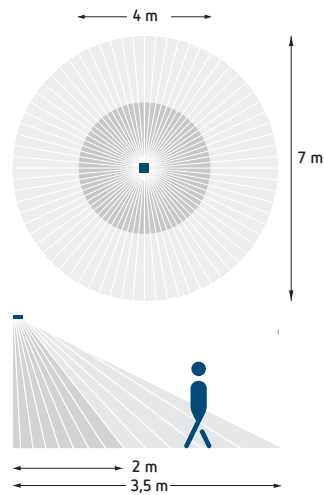

① recommended installation height: 2.5 m

5. Walking test

The walking test is used to test the detection area.

- Set the time delay potentiometer (TIME 1) to **Test**. The motion detector only reacts to movements, brightness measurement is switched off.
- Walk through the detection area. Every detected movement is indicated by the LED, and the light switch contact closes for 2 s.

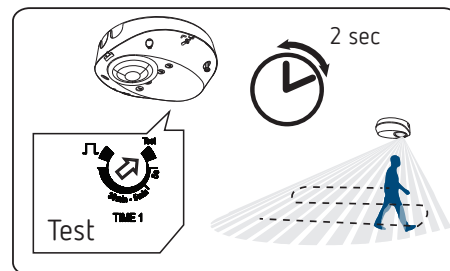

6. Setting

The motion detector LUXA 103-100 AP has 3 potentiometers for setting the time delay (TIME 1), brightness (LUX) and sensitivity (METRES); in the case of LUXA 103-101 AP the HVAC time (TIME 2) can also be set.

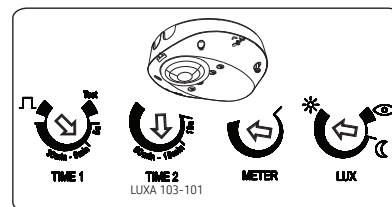

Setting the brightness (LUX)

You can set different brightness values with the brightness potentiometer (LUX).

- If you want to change the preset brightness
- Set the potentiometer to the desired brightness (10 – 2000 lux = ☀)



If you want a specific brightness value to be learned using the **teach-in function**

- At the desired brightness, set the potentiometer to . The LED flashes for 25 s, afterwards the measured brightness value is accepted.
- Leave the potentiometer at position .



Setting the time delay (TIME 1)

If the motion detector detects no further movement, it switches off after the set time delay.

If you want to change the preset time

- Set the potentiometer to the desired time (5 s - 30 min).

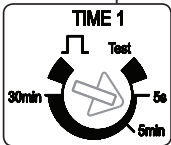

If you want to use the **pulse function** (e.g. for a staircase light timer switch)

- Set the potentiometer to . The presence detector for "staircase light timer switch" operation is on for 1 s and off for 9 s.

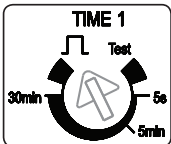

Setting the HVAC time (TIME 2) (only LUXA 103-101 AP)

- Set the potentiometer to the desired time (10 s - 60 min).

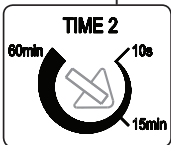

HVAC switches on regardless of brightness

Setting the sensitivity (METRES)

You can reduce the sensitivity in order to avoid switching errors.

- Set potentiometer METRES to the desired sensitivity.

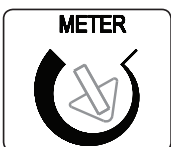

Manual operation

The lighting can be manually switched on/off via a button.

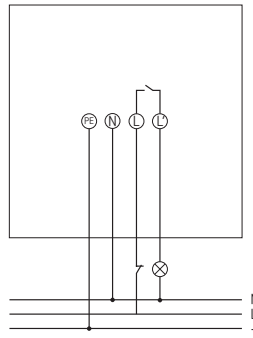

When the light is off

- Briefly press button once
→ The light is on for the time set on the potentiometer; then the detector goes into automatic mode

Limiting the detection area

- Use the supplied cover clips to adjust the motion detector to the desired detection area.
- Remove the required section of the cover clip by using pliers or similar.
- Then place it on the lens.

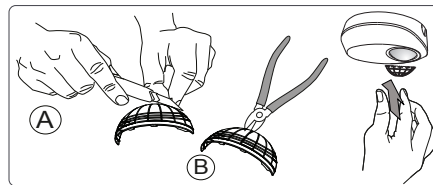

7. Technical data

Operating voltage	230 V AC ±10% - 15%
Frequency	50 Hz/60 Hz
Upstream protection device	10 A
Standby output	0.5 W
Switching capacity min.	10 mA
Protection rating	IP 44 in accordance with EN 60529
Protection class	II
Operating temperature	0 °C ... +45 °C
Brightness setting range	10 – 2000 lx/∞
Duty cycle range	LUXA 103-100 AP: 5 s – 30 min for lighting LUXA 103-101 AP: 5 s – 30 min for lighting 10 s – 60 min for HVAC
Detection angle	360°
Detection area	lateral/frontal: 7 m/4 m
Installation height	2 – 3 m (2.5 m recommended)
Light switch output	μ contact 230 V AC zero-cross switching
Switch output HVAC (D1/D2)	LUXA 103-101 AP: 5 A (at 250 V AC, cos φ = 1)
Incandescent lamp load	max. 2000 W
Halogen lamp load	max. 2000 W
Low-voltage halogen lamps (transformer)	max. 1000 VA
Fluorescent lamps (LLB low-loss ballasts): parallel compensated	max. 900 VA (100 μF)
Fluorescent lamps (EB – electronic ballasts)	600 W
Compact fluorescent lamps (EB)	400 W
LED lamps (< 2 W)	35 W
LED lamps (> 2 W)	400 W

8. Contact

Theben AG

Hohenbergstr. 32

72401 Haigerloch

GERMANY

Tel. +49 7474 692-0

Fax +49 7474 692-150

Hotline

Tel. +49 7474 692-369

hotline@theben.de

Addresses, telephone numbers etc.

www.theben.de