



# Polyslab

*'Concrete is History...'*



## Product List

May 2009

# Consumer

# TABLE OF CONTENTS

Polyslab Products: .....	3
Polyslab Small .....	3
Polyslab Medium.....	3
Polyslab Large .....	3
Polyslab 2-in-1 Design .....	3
Polyslab Tray .....	3
Polyslab Pump Covers.....	4
General Information .....	5

# Polyslab Products

## Polyslab Small

Hamer Code	Reference Number	Size	Weight	Load Capacity
PS339	PSAC-SML	339 x 639 x 51mm	2.1kg	120kg

Ideal for small one horsepower air conditioning units, pool and irrigation pumps and camping equipment.



B4 Polyslab

## Polyslab Medium

Hamer Code	Reference Number	Size	Weight	Load Capacity
PS465	PSAC-MED	465 x 885 x 51mm	2.4kg	120kg

Built to suit 95% of the domestic and light commercial split system air conditioning market. From 2.5kw right through to 15kw upright units.



## Polyslab Large

Hamer Code	Reference Number	Size	Weight	Load Capacity
PS1130	PSAC-LGE	1130 x 650 x 51mm	6.8kg	160kg

Designed for large ducted systems and multiple mini-split system air conditioning units.



## Polyslab 2-in-1 Design

Hamer Code	Reference Number	Size	Weight	Load Capacity
PS690	PSHWS-LGE	690 x 690 x 51mm	2.5kg	500kg
PS695	PSHWS-SML	500 x 500 x 51mm	1.6kg	500kg

The *2 in 1 design* removes the need for a concrete base and anti corrosion pad or `pizza`. Built to AS/NZ 3500.4 Standards. Improved surface/ground contact allows for greater stability, especially compared to that of other plastic products on the market. Built to accommodate more than 95% of residential and light commercial Hot Water Systems. Priced the same, if not better, than ripple top concrete slabs.

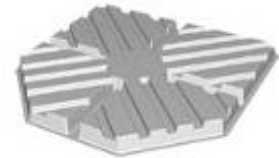

## Polyslab Tray

Hamer Code	Reference Number	Size	Weight	Load Capacity
PSTRAY	PSTRAY	Various	2.1kg	500kg

Will not dent or damage easily, unlike a steel or copper tray, whilst being only a fraction of the price. Built to accommodate 95% of residential and light commercial Hot Water Systems.

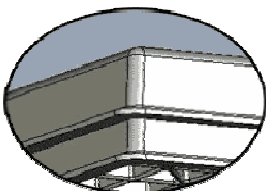

POLYSLABS are designed to be stackable, dramatically reducing freight and warehousing costs.

B4 Polyslab

## Polyslab Pump Cover

Hamer Code	Reference Number	Colour	Load Capacity
PSPC-MER	PSPC-MER	Beige	120kg
PSPC-RIV	PSPC-RIV	Light Green	120kg



- Includes Polyslab base & pump cover
- Rated to over 120kg
- Easy to install replaces the need for heavy and hard to handle concrete
- Pump/equipment can be easily secured to the base
- Base raises the pump safely up off the ground
- Multiple ventilation points for flow through ventilation
- Easy to follow cut and snap entry points (allowing for common pipe dimensions)
- Caters for majority of domestic and light industrial applications
- Available in Beige or Green

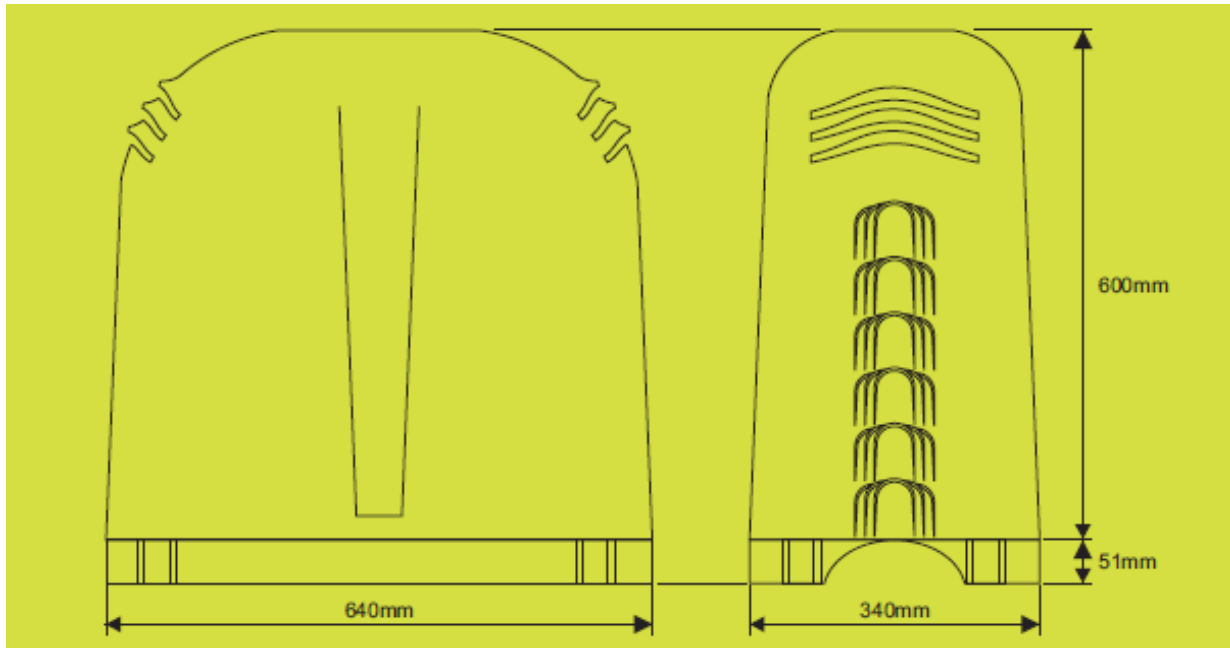

# POLYSLAB™

Patent Pending  
Copyright POLYSLAB Australia  
Australian  
Made & Owned



**"Concrete Is History..."**

**The smart choice for an  
easy & permanent base  
for split system  
Air Conditioners and more...**

- CONCRETE = Hard work, Injuries, Litigation, rehab & down time
- High strength & UV resistant, designed to last
- Light & easy to use - only 3.8 kg
- Avoid heavy lifting & the associated costs & pitfalls (WPHS)
- Increase productivity & profits
- Available from major wholesalers, eliminate runaround for supplies
- Space saving design, carry more stock

[www.polyslab.com.au](http://www.polyslab.com.au)

Also available for:  
Hot Water Systems, Swimming Pool Equipment,  
Camping Equipment

## INSTALLATION RECOMMENDATIONS

- 1) Level uneven surface and ensure footing is firm



- 2) THIS STEP OPTIONAL\*

- a) Place a mound of loose soil on top of levelled surface  
b) Shuffle POLYSLAB™ until firmly on level surface



*\*This step is not necessary, however it is strongly recommended for increased stability, especially on loose and unfirm surfaces*

- 3) Finally ensure the POLYSLAB™ product is level and firmly in place



- 4) Where bricks or other objects must be used to increase the final height, ensure that the underside of POLYSLAB™ is sufficiently supported

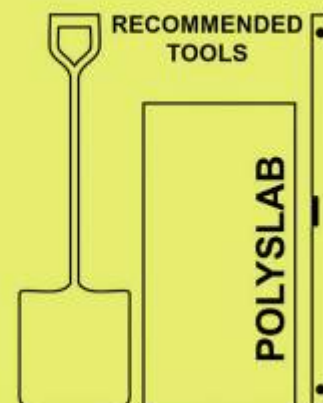
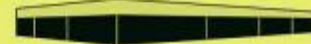

# **POLYSLAB™**

Patent Pending  
Copyright POLYSLAB Australia



***"Concrete Is History..."***

**The smart choice for an easy & permanent base   
for split system Air Conditioners and more...**

- ☞ **CONCRETE = Hard work, Injuries, Litigation, rehab & down time**
- ☞ **High strength & UV resistant, designed to last**
- ☞ **Light & easy to use - only 3.6 kg**
- ☞ **Avoid heavy lifting & the associated costs & pitfalls**
- ☞ **Increase productivity & profits**
- ☞ **Available from major wholesalers, eliminate runaround for supplies**
- ☞ **Space saving design, carry more stock**

**[www.polyslab.com.au](http://www.polyslab.com.au)**

Also available for:

**Hot Water Systems, Swimming Pool Equipment, Camping Equipment**

